

Let it Rain

***Solutions for fast, precise
cuts in thin walled K-Style
& half round gutter.***

Malco[®]



SL15114

Quick-Action™ Gutter Outlet Saws

& Combination Arbor & High Speed Pilot Drill

Fine-tooth, shallow-cup, hole saws for safe, fast, clean cuts in thin walled and half round gutter. Five saw selections, including true metric sizes, ensure that downspout fits snug and flush with gutter and drop every time.



GOS1EV

60 mm (2.375 in.)

GOS2EV

70 mm (2.75 in.)

GOS3EV

78 mm (3 in.)

GOS4EV

90 mm (3.5")

GOS5EV

100 mm (4")



GOSA1EV

Combination Arbor and High Speed Pilot Drill.

Designed specifically for use with Malco Gutter Outlet Saws. Tapered compression spring collar on pilot ejects metal slug.



Clean cuts with compression spring ejection!

For use with a 1/2-in. (13 mm) cordless or corded electric drill and a Malco Combination Arbor and High Speed Pilot Drill. High speed steel teeth set at 10 per-inch (per 25.4 mm) will not grab or twist gutter material, even when cutting half round.



Outlet Saw cutting progression in half round gutter.

Operating the Gutter Outlet Saw at low drill speed (approximately 200 RPM) and slightly angling the saw cup to one side produces optimum cutting speed and precise diameters. The shallow cup, and a short pilot drill projection of only 7/16-in. (11 mm) beyond teeth, ensure safe, controlled engagement in K-style and half-round gutter. A tapered compression spring collar on the arbor pilot drill bit ejects the cut metal slug.

Service life of saw averages a minimum of 50 hole cuts in common gutter materials and capacities.

Specifications

Quick-Action™ Gutter Outlet Saws

Catalog Number	Hole Diameter mm (in.)	Cutting Depth mm (in.)
GOS1EV	60 (2.375)	25.4 (1)
GOS2EV	70 (2.75)	25.4 (1)
GOS3EV	78 (3)	25.4 (1)
GOS4EV	90 (3.5)	25.4 (1)
GOS5EV	100 (4)	25.4 (1)

Combination Arbor & High Speed Pilot Drill

Catalog Number	Pilot Drill Bit	Arbor Shank mm (in.)	Drill Requirements
GOSA1EV	5.9 mm High Speed Steel	10 (13/32)	1/2 in (13 mm) Chuck

Capacities



Aluminum - 0.43 -0.81 mm (.017 - .032 in)



Zinc Coated Aluminum - 0.46 mm (.018 in)

Galvanized Aluminum - 0.58 mm (.023 in)

Painted Steel - 0.53 mm (.021 in)

Copper - 22 oz.

Gutter Outlet Tools

Specifically designed for punching rectangular square outlet holes in metal gutter! Faster, cleaner cuts ensure downspout always fits flush to gutter.

Malco's New Gutter Outlet Tool has been engineered with ample throat clearance and open sides, to allow any of the 6 available punches access to quickly line up cuts in both horizontal and vertical directions. And the powerful threaded drive requires only moderate force and a steady turning motion on the handle to ensure the metal slug will not hang up in the work piece when recycling. The durable cast aluminum tool frame offers lightweight portability and long service life on the job. Fastener holes are provided in the tool base for optional bench-mount operation. High carbon steel punch blades ensure a long lasting cutting edge and they are also resharpenable. **Punch and Die Kits are available separately for easy replacement or for use as additional interchangeable sizes.** All components feature weather resistant finishes for dependable operation and storage in a variety of climates including dry air, humidity, rain, snow and temperature extremes.

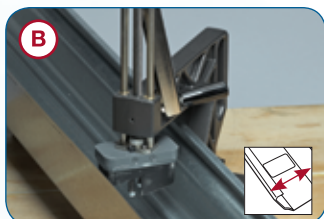
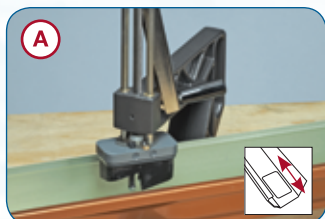

Ample throat clearance and open sides allow the punch access over the front or back edge of gutter to quickly line up cuts in either "A" or "B" direction.

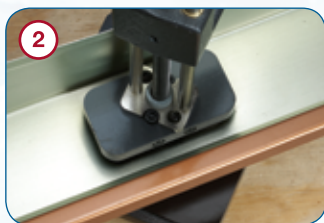

The powerful screw drive requires only moderate force and a steady cranking motion on the handle to ensure that the metal slug will not hang up in the work piece when recycling.



Fastener holes are provided in the tool base for optimal bench-mount operation.



The punch and die is easily replaced or interchanged with separately purchased Punch and Die Replacement Kits.

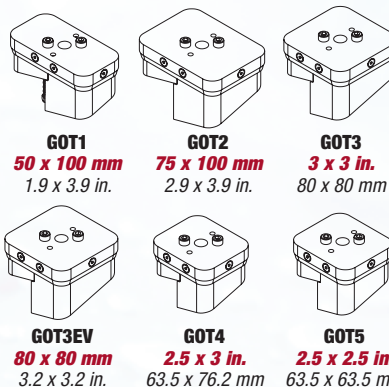

Easily interchange different punch and die sets!

GOT1
50 x 100 mm
1.9 x 3.9 in.
(Punch & Die)



Specifications

Gutter Outlet Tools with Punch & Dies Supplied

Catalog Number	Punch & Die Dimensions mm (in.)	Tool Dimensions cm (in.)	Nominal Tool Weight with Punch and Die kg (lbs.)	Separate Punch & Die Kit Number
GOT1	50 x 100 (1.9 x 3.9)	33 x 15 x 43 (13 x 6 x 17)	6.62 (14.6)	GOTRP1
GOT2	75 x 100 (2.9 x 3.9)	33 x 15 x 43 (13 x 6 x 17)	6.62 (14.6)	GOTRP2
GOT3	80 x 80 (3 x 3)	33 x 15 x 43 (13 x 6 x 17)	6.62 (14.6)	GOTRP3
GOT3EV	80 x 80 (3.2 x 3.2)	33 x 15 x 43 (13 x 6 x 17)	6.62 (14.6)	GOTRP3EV
GOT4	63.5 x 76.2 (2.5 x 3)	33 x 15 x 43 (13 x 6 x 17)	6.62 (14.6)	GOTRP4
GOT5	63.5 x 63.5 (2.5 x 2.5)	33 x 15 x 43 (13 x 6 x 17)	6.62 (14.6)	GOTRP5

Capacities



Aluminum - 0.43 - 0.81 mm (.017 - .032 in)



Zinc Coated Aluminum - 0.58 mm (.023 in)
Painted Steel - 0.53 mm (.021 in)

Gutter & Downspout Tools

Gutter Nail Driver

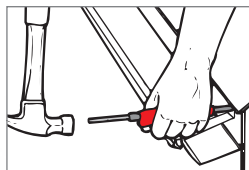

Working from
Above

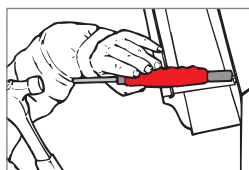

Working from
Below



GND

Works anywhere to attach gutter to fascia with ease.

Use the Malco Gutter Nail Driver with hidden hangers and 8D galvanized nails to hang aluminum or steel gutters. A non-slip ergonomic grip provides multiple positions for grasping tool and working from above or below roof overhang. Durable 2-piece steel construction plus weather resistant zinc and nickel plating assure long service life of this professional quality tool.

Snap Lock Punch

*Not recommended
for heavy sheet metal.*



SL2R

Ideal for end caps on gutter.

Slide adjustment for throat depth allows settings from 1/4" to 5/8" (6 to 16 mm) depth. Also used to crimp end caps on gutter. Nickel plate and black oxide finish. Formed metal cutting jaws. Ergonomic Redline Handles with unique one-hand operation latch offer maximum compound leverage performance and natural fit and feel.

5 Blade Crimper



C4R

Produces a double crimp that downsizes without deforming downspout; walls stay square for a tight fitting, leakproof connection.

Tool also features rust resistant plating. Ergonomic Redline Handles with unique one-hand operation latch offer maximum compound leverage performance and natural fit and feel.

Single Crimper



SC2

Light Duty tool without grips.

Makes a single crimp for downsizing aluminum downspouts.

Specifications

Catalog Number	Description	Throat Depth mm (in.)	Variable Leverage Ratio (High / Low) throughout stroke		Jaws	Length mm (in.)	Net Wt. g (oz.)
GND	Gutter Nail Driver	—	—		—	194 (7-5/8)	199 (7)
SL2R	One-Inch Hand Notcher	6 to 16 (1/4 to 5/8)	—		—	203 (8)	454 (16)
C4R	5 Blade Crimper	31.8 (1-1/4)	7.1 to 1.0 - 9.8 to 1.0		Carbon Steel	229 (9)	454 (16)
SC2	Single Crimper	28.6 (1-1/8)	—		—	203 (8)	227 (8)
CAPACITIES		Material	Aluminum	Copper	Stainless Steel 26 Gauge	Galvanized Steel 24 Gauge	Mild Steel 24 Gauge
C4R	inches (mm)	0.035 (0.89)	0.023 (0.58)	0.018 (0.46)	0.028 (0.71)	0.024 (0.61)	

Malco Products, Inc. | Annandale, Minnesota, U.S.A. | www.malcotools.com | ©2013

U.S. 320-274-7387 - 800-328-3530 | Canada: 320-274-2376 • 800-219-1085 | International: 01-320-274-2376